

GMAI60SMF

GRI

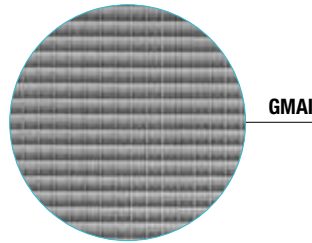
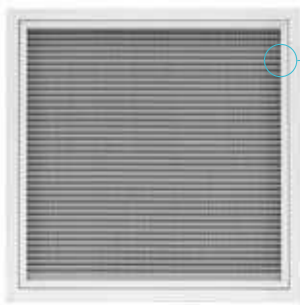

PREZZI - PRICES

STOCK

	CON FILTRO WITH FILTER							
BxH	GMAI60SMF	GMAI60SM	FILTRO - FILTER	SC	PDZ1	PDZ11	PDZ2	PDZ2 2
mm	€	€	€	€	€	€	€	€
595x595								

VERNICIATURA - PAINTING:

Colori RAL 9010 - 9016: + 15% - Color RAL 9010 - 9016: + 15%
Altri colori: prezzi a richiesta - Different colors: prices on request

DESCRIZIONI - DESCRIPTIONS:

GMAI60SMF: Griglia a maglia quadra 13x13 mm, inclinata di 45°, smontabile, dimensione 595x595 mm esterno cornice, con filtro incluso - Egg crate grille 13x13 mm pitch inclined 45° with removable core, 595x595 overall size, with filter
GMAI60SM: Griglia a maglia quadra 13x13 mm, inclinata di 45°, smontabile, dimensione 595x595 mm esterno cornice, senza filtro - Egg crate grille 13x13 mm pitch inclined 45° with removable core, 595x595 overall size, without filter

CARATTERISTICHE:

Griglie a maglia quadra 13x13 mm, inclinata di 45° smontabile per controsoffitto dim. 595x595 esterno cornice.

COSTRUZIONE:

Alluminio anodizzato.

IMPIEGO:

A controsoffitto, in ripresa.

FISSAGGIO:

Fissaggio con clips o su richiesta con viti frontali.

ACCESSORI:

- Plenum in acciaio zincato standard e isolato.
- Serranda di taratura in acciaio zincato con alette a movimento contrapposto.

CHARACTERISTICS:

Egg crate grilles 13x13 mm pitch, inclined of 45° with removable core, for false ceilings 595x595 overall size.

CONSTRUCTION:

Anodized aluminium.

UTILIZATION:

For false ceilings installation and for air intake.

FIXING:

Fixing by using clips or frontal screws on demand.

ACCESSORIES:

- Galvanized steel plenum, standard or insulated.
- Calibration damper made of galvanized steel and fins with opposite movement.

DISEGNI - DRAWINGS

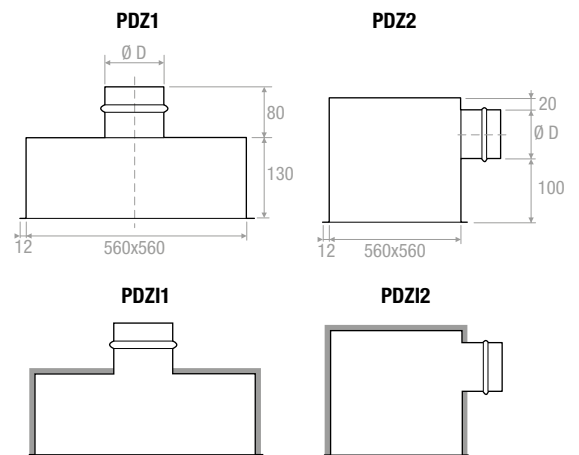
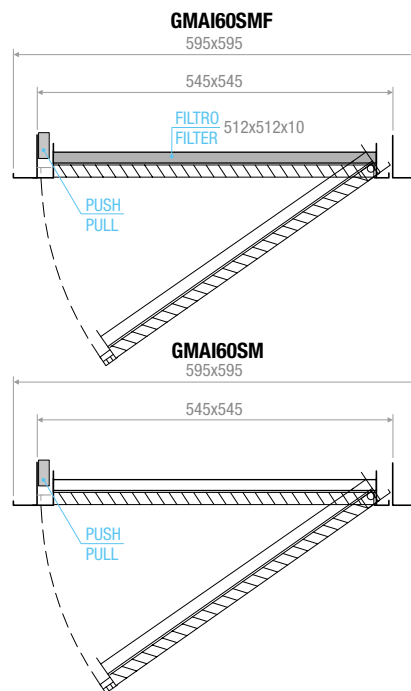

Plenum isolato esternamente spessore 6 mm
Plenum externally insulated thickness 6 mm

DIAGRAMMA SCELTA RAPIDA - QUICK SELECTION DIAGRAM



TABELLA DI SELEZIONE - SELECTION TABLE

Modello - Model	A _k [m²]	Q [m³/h]		L _{WA} [dB(A)]		Dp _t [Pa]	
		min	max	min	max	min	max
GMAI60SM	0,2375	2640	5210	41	60	5	20
GMAI60SMF	0,2375	1070	2860	-	43	10	50

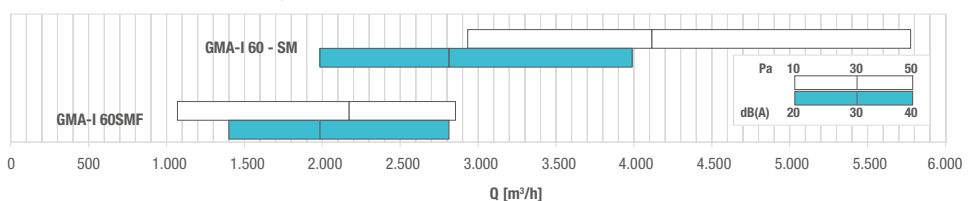